

■ 特征 / Features

- 闭磁路 小型低背功率电感
Shielded, small foot print and low profile power inductors.
3.0mm × 3.0mm (Typ) × h2.0mm (Max)
- 闭磁路结构 低噪音, 少漏磁
Low noise and flux by closed magnetic path structure.

■ 应用 / Applications

- 手机, 液晶显示屏等
DC/DC转换器用
DC/DC converters for
Cellular phones, LCD Panel and others.

■ 外形尺寸 · 焊盘模式 / Dimensions · Land Pattern

(Unit : mm)

Recommended Land Pattern (Unit : mm)

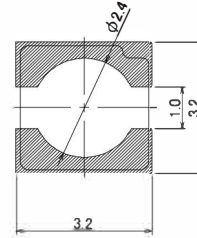
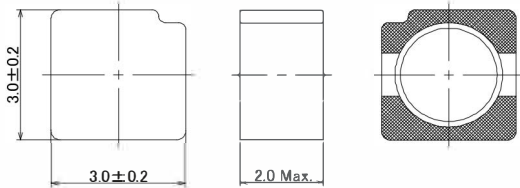

■ 规格 / Specifications

系列 Series	品名型号 Part number	电感量 L [μ H] Inductance *(1)	直流阻抗 Rdc [Ω] DC resistance *(2)	额定电流 Idc1 / Idc2 [A] Rated current *(3)	使用温度范围 Ta [°C] Operating temperature range *(4)
MIB3020-W	MIB3020M-4R7W	4.7±20%	0.085	1.65 / 1.84	-40°C ~ 125°C
	MIB3020M-6R8W	6.8±20%	0.12	1.44 / 1.56	
	MIB3020M-100W	10.0±20%	0.16	1.20 / 1.30	
	MIB3020M-150W	15.0±20%	0.23	0.98 / 1.10	

*Note: (1) Ta=25°C, Idc=0A (2) Ta=25°C
(3) Idc1: 电感变化率 Inductance change ratio $|\Delta L/L| \leq 30\%$, Idc2: 温度上升 Temperature rise $\Delta T \leq 40^\circ\text{C}$
(4) 包括自温上升 Including self temperature rise

(代表值/Typical)

■ 直流叠加特性 / DC bias current characteristics

