

■ 特征 / Features

- 闭磁路 小型低背功率电感
Shielded, small foot print and low profile power inductors.
3.0mm × 3.0mm (Typ) × h1.5mm (Max)
- 闭磁路结构 低噪音, 少漏磁
Low noise and flux by closed magnetic path structure.

■ 应用 / Applications

- 手机, 液晶显示屏等
DC/DC转换器用
DC/DC converters for
Cellular phones, LCD Panel and others.

■ 外形尺寸 · 焊盘模式 / Dimensions · Land Pattern

(Unit : mm)

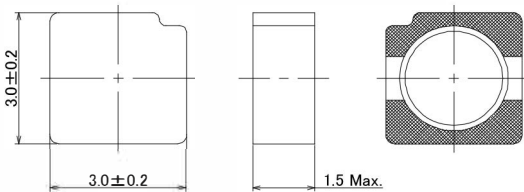

Recommended Land Pattern (Unit : mm)

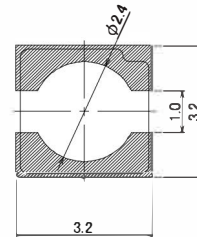

■ 规格 / Specifications

系列 Series	品名型号 Part number	电感量 L [μ H] Inductance *(1)	直流阻抗 Rdc [Ω] DC resistance *(2)	额定电流 Idc1 / Idc2 [A] Rated current *(3)	使用温度范围 Ta [°C] Operating temperature range *(4)
MIB3015-W	MIB3015M-2R2W	2.2±20%	0.064	2.13 / 2.17	-40°C ~ 125°C
	MIB3015M-3R3W	3.3±20%	0.089	1.75 / 1.77	
	MIB3015M-4R7W	4.7±20%	0.12	1.52 / 1.53	
	MIB3015M-6R8W	6.8±20%	0.16	1.31 / 1.10	
	MIB3015M-100W	10.0±20%	0.24	1.03 / 1.03	
	MIB3015M-150W	15.0±20%	0.33	0.79 / 0.92	
	MIB3015M-220W	22.0±20%	0.51	0.64 / 0.71	
	MIB3015M-330W	33.0±20%	0.68	0.52 / 0.61	

(1) Ta=25°C, Idc=0A (2) Ta=25°C

*Note: (3) Idc1: 电感变化率 Inductance change ratio $|\Delta L/L| \leq 30\%$, Idc2: 温度上升 Temperature rise $\Delta T \leq 40^\circ\text{C}$

(4) 包括自温上升 Including self temperature rise

(代表值/Typical)

■ 直流叠加特性 / DC bias current characteristics

