

PACKAGE FORM DETAILS

■ Taping

Reel Type Size

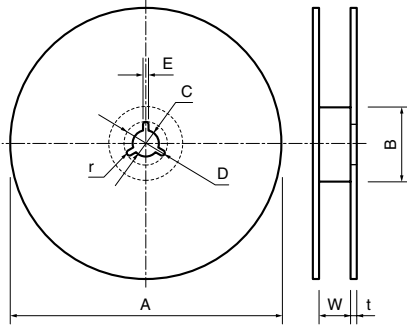

Unit : mm

Series	Size	A	B	C	D	E	W	t	r
RC, KC VC, VH XC	11,20, 30,40	178±2	over 50	13.0 ±0.5	21.0 ±0.8	2.0±0.5	9.0±0.3	2.5±0.5	0.5
	63,69 70,80						13.0±0.3	2.5±0.5	
	70						329±2	over 50	
KS VS RS	80						17.5±1.5	2.5±0.5	0.5

■ Features

- Plastic carrier tape for 800, 1000 and 1500pcs. (70, 80 size)

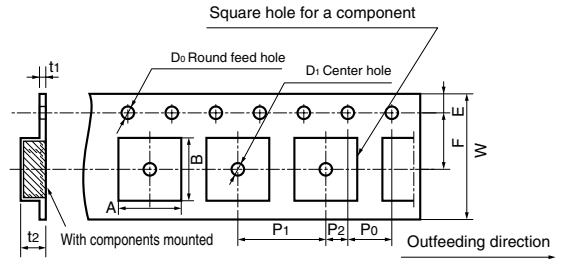

Unit : mm

Series	Size	A	B	W	F	E	P <sub>1</sub>	P <sub>2</sub>	P <sub>0</sub>	D <sub>0</sub>	D <sub>1</sub>	t <sub>1</sub>	t <sub>2</sub>
RC KC VC VH	70	3.6 ±0.2	4.9 ±0.2	12.0 ±0.2	5.50 ±0.05	1.75 ±0.1	8.0 ±0.1	2.0 ±0.05	4.0 ±0.1	1.5 +0.1 -0	over 1.5 ±0.05	under 0.6 ±0.05	under 3.0 ±0.1
	80	5.4 ±0.2	6.1 ±0.2										
XC	63	3.1 ±0.3	6.2 ±0.2										under 2.7 ±0.1
KS VS RS	70	3.9 ±0.1	5.6 ±0.1	12.0 ±0.1	5.5 ±0.1			2.0 ±0.1			1.15 ±0.05	0.40 ±0.05	5.6 ±0.1
	80	5.75 ±0.1	7.05 ±0.1	16.0 ±0.2	7.5 ±0.1						1.15 ±0.05		6.55 ±0.1

Taping Specifications

- Paper carrier tape for 4,000pcs. (11,20 size)

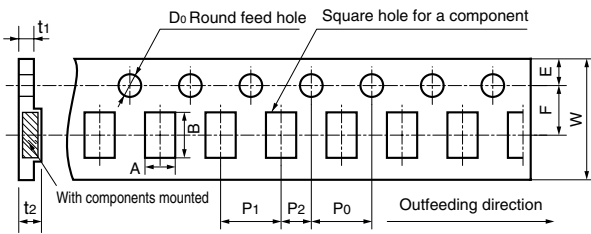

Unit : mm

Series	Size	A	B	W	F	E	P <sub>1</sub>	P <sub>2</sub>	P <sub>0</sub>	D <sub>0</sub>	t <sub>1</sub>	t <sub>2</sub>
KC	11	1.1 ±0.2	1.9 ±0.2	8.0 ±0.3	3.50 ±0.05	1.75 ±0.1	4.0 ±0.1	2.0 ±0.05	4.0 ±0.1	1.5 +0.1 -0	under 1.0	under 1.1
	20	1.62 ±0.2	2.3 ±0.2									

- Plastic carrier tape for 2,000pcs. (Partially 20,30 size)

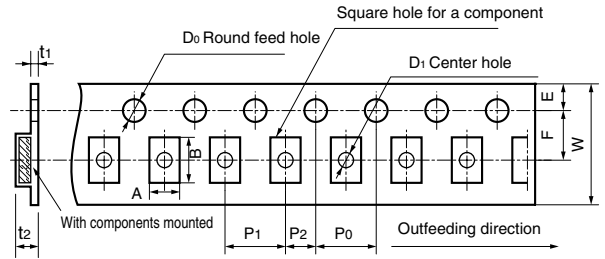

Unit : mm

Series	Size	A	B	W	F	E	P <sub>1</sub>	P <sub>2</sub>	P <sub>0</sub>	D <sub>0</sub>	D <sub>1</sub>	t <sub>1</sub>	t <sub>2</sub>
RC KC VC	20	1.45 ±0.2	2.3 ±0.2	8.0 ±0.2	3.50 ±0.05	1.75 ±0.1	4.0 ±0.1	2.0 ±0.05	4.0 ±0.1	1.5 +0.1 -0	1.15 ±0.05	under 0.6 ±0.05	under 2.0 ±0.1
	30	2.0 ±0.2	3.6 ±0.2										
	40	2.9 ±0.2	4.9 ±0.2										

■ Taping of VH, XC Series

Reel Type Size

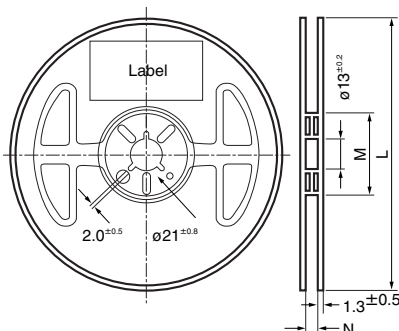

Taping Specifications

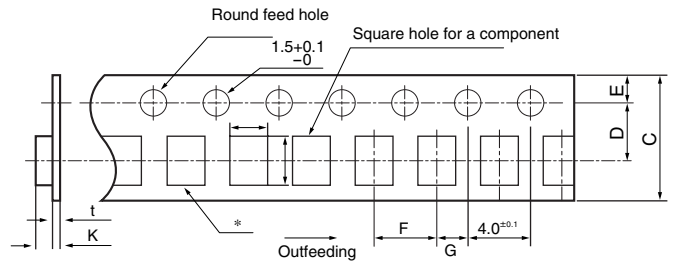

Unit : mm

Size code	A ±0.1	B ±0.1	C ±0.1	D ±0.1	E ±0.1	F ±0.1	G ±0.1	K MAX	t MAX	L 0 -3	M +1 0	N +0.3	Standard packaging volume (pc./reel)
35	1.7	3.7	8.0	3.5	1.75	4.0	2.0	2.5	0.3	180	60	9	2000
38	3.1	3.8	8.0	3.5	1.75	4.0	2.0	2.5	0.3	180	60	9	
44	2.25	4.95	12.0	5.65	1.75	4.0	2.0	2.5	0.3	180	60	9	
47	3.6	4.9	12.0	5.5	1.75	8.0	2.0	2.5	0.3	180	60	13	T≤2.2/ 1000 T>2.2/ 700